

# Disney's Grand Floridian Resort & Spa

Relish in the elegance of a Disney Deluxe Resort that pays homage to Palm Beach's golden era. Enjoy the shady verandahs, magnificent stained glass and glittering chandeliers of this timeless Victorian-style Resort and spa. Plus, *The Villas at Disney's Grand Floridian Resort & Spa* offers the ultimate in pampered luxury.



## Room Accommodations

- 842 Rooms, 25 Suites, 147 Villas.
- Standard rooms accommodate up to five Guests, plus one child under age 3 in a crib.
- All rooms have two queen-size beds or one king-size bed and a day bed.
- Guests choosing **Club Level** accommodations at the *Royal Palm Club* and *Sugarloaf Lodge* receive personalized concierge service and lounge with continental breakfast, midday snacks and evening wine, hors d'oeuvres, cordials and desserts.

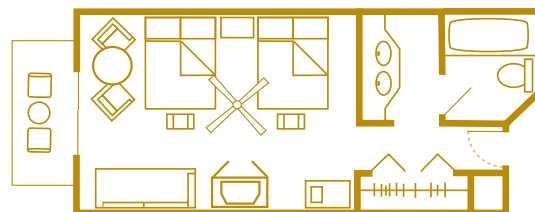

Typical Standard Room with 2 queen-size beds and 1 day bed, 448 sq. ft.  
Accommodates up to five Guests plus one child under age 3 in a crib.



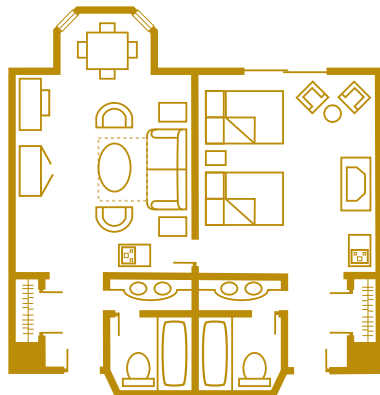

*Typical 1-Bedroom Suite with 2 queen-size beds and 1 queen sleeper sofa, 931 sq. ft. Accommodates up to six Guests plus one child under age 3 in a crib.*

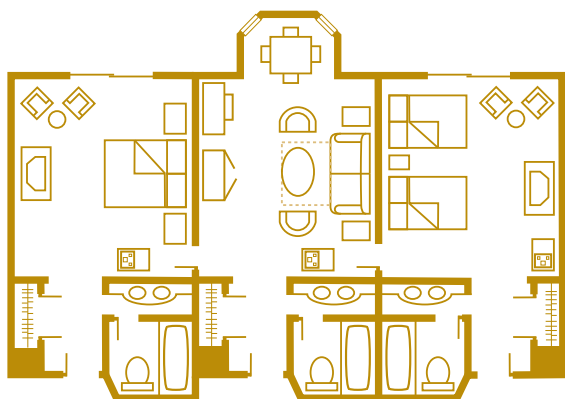

*Typical 2-Bedroom Suite with 1 king-size bed, 2 queen-size beds and 1 queen sleeper sofa, 1,362 sq. ft. Accommodates up to eight Guests plus one child under age 3 in a crib.*

## Dining

### Signature Dining

- *Cítricos* – Dinner offering American cuisine celebrating savory Mediterranean flavors – steaks on an oak-fired grill, seasonal seafood selections and creative pasta dishes.
- *Narcoossee's* – Dinner featuring seafood and more in this waterfront restaurant that is nestled on the shores of Seven Seas Lagoon.
- *Victoria & Albert's* – A prix fixe elegant, intimate seven-course dinner menu in a Victorian setting, offering Modern American cuisine. Extensive wine list; jacket required. Diners must be 10 years of age and older.

### Casual Table Service Dining

- *Grand Floridian Cafe* – Breakfast, lunch and dinner.

### Disney Character Dining

- *Supercalifragilistic Breakfast at 1900 Park Fare* – All-you-care-to-enjoy buffet.
- *Cinderella's Happily Ever After Dinner at 1900 Park Fare* – All-you-care-to-enjoy dinner buffet.

### Quick-Service Dining

- *Gasparilla Island Grill* – Breakfast, lunch, dinner and snacks. Open 24 hours.
- *Beaches Pool Bar & Grill* – Lunch, dinner and snacks.

### Other Dining Options

- Private dining, lounge serving appetizers, poolside snack bar, beach bar, afternoon tea and room service.





## Recreation

- Two heated swimming pools, including the Beach Pool with a themed slide, aquatic play area, white sand beaches for sunbathing.
- Senses Spa, health club, campfire, fishing, poolside cabana rentals, marina watercraft rental including the Grand 1 Yacht, arcade and recreation activities including Disney movies under the stars and new balance® RUNNING TRAIL.

## Transportation

- Monorail service to Magic Kingdom® Park, Epcot® and select Disney Resort hotels.
- Water launch service to Magic Kingdom Park and select Disney Resort hotels.
- Bus service to other Walt Disney World® Resort locations.



## The Villas at Disney's Grand Floridian Resort & Spa

*A limited number of 3-Bedroom Grand Villas accommodating up to 12 Guests may be available upon request.*

### Villa Accommodations

**TWO-BEDROOM VILLAS** accommodate up to nine Guests (select Two-Bedroom Villas sleep up to ten Guests), plus one child under age 3 in a crib, and offer a fully equipped kitchen, master bedroom, second bedroom, two full bathrooms, washer and dryer, DVD player and private porch or balcony.

**ONE-BEDROOM VILLAS** accommodate up to five Guests, plus one child under age 3 in a crib, and offer a fully equipped kitchen, king-size bed in master bedroom, queen-size sleeper sofa and bunk-size pull-down bed in living room, washer and dryer and private porch or balcony.

**DELUXE STUDIOS** accommodate up to five Guests, plus one child under age 3 in a crib, and have a kitchenette, one queen-size bed, double-size sleeper sofa, bunk-size pull-down bed and private porch or balcony.

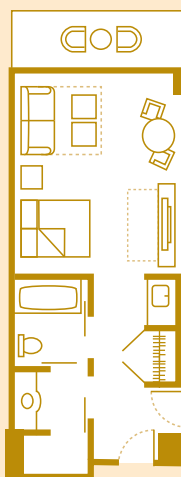

*Typical Deluxe Studio, 374 sq. ft. Accommodates up to five Guests plus one child under age 3 in a crib.*

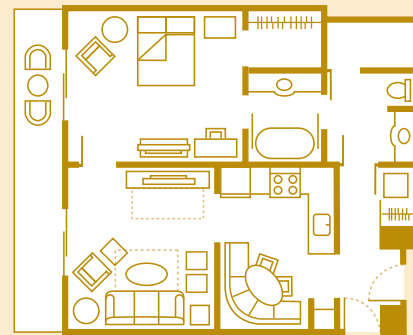

*Typical 1-Bedroom Villa, 844 sq. ft. Accommodates up to five Guests plus one child under age 3 in a crib.*

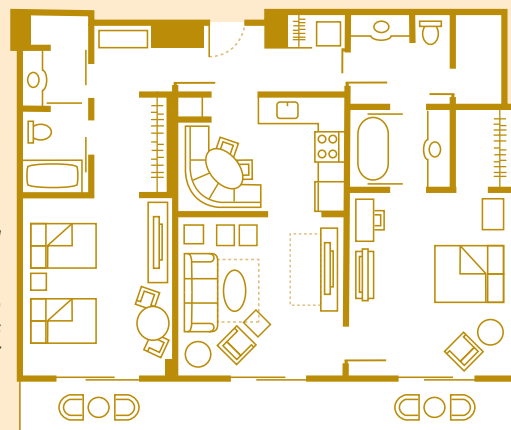

*Typical 2-Bedroom Villa, 1,232 sq. ft. Accommodates up to nine Guests plus one child under age 3 in a crib.*



**1-Bedroom Villa**